

# Absorbed Glass Mat VRLA Industrial Battery Block



Part No. D12600D

12V 58Ah (20hr)

Discover® D Series VRLA Industrial Batteries provide superior high integrity and reliability for commercial, industrial, and private applications. The maintenance-free valve regulated lead acid (VRLA) construction make Discover® D Series Batteries the definitive choice for mobility and home medical equipment (HME), broadband and cable TV (CATV), uninterruptible power supplies (UPS), telecommunications, solar and renewable energy, electronics and security, marine and RV, and utility applications.

## D Series Features And Benefits

- Tank formed lead-tin-calcium plates deliver consistent dependable performance and promote long life.
- Epoxy post seal promotes trouble-free service and eliminates acid egress. Optional terminals available.
- 99% gas recombination for extended life in float applications.
- Flame retardant ABS case and cover with UL94 V0 rating available.
- UL 924 recognized flame arresting low pressure safety vents.
- 98% Recyclable.
- Classified as a Non-Spillable battery and is not restricted for transportation by air (IATA/ICAO prov. 67), Surface (DOT-CFR-HMR49), Water Per IMDG Amendment 27).

Part No.  
D12600D

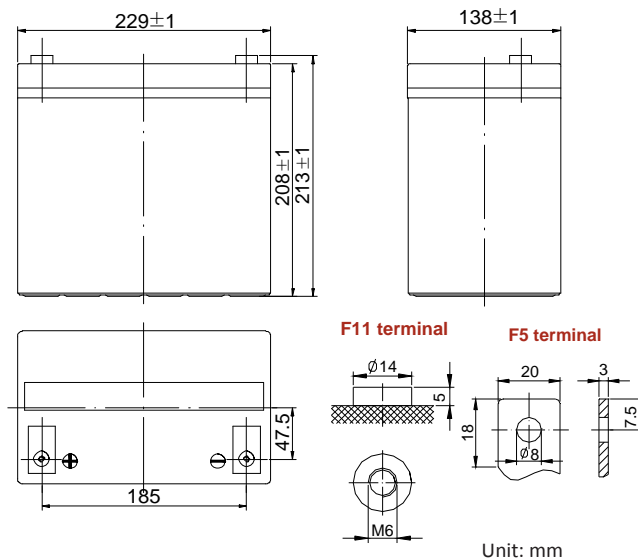

## D12600D Specifications

Length	229 mm	9.02 in
Width	138 mm	5.43 in
Height	208 mm	8.19 in
Total Height	213 mm	8.38 in
Weight	16.5 kg	36.4 lb
Volts	12V	
Number of Cells	6	
Terminal Torque	N/A	
Terminal Type	M6 F11 (F5 optional)	
Short Circuit	1450 Amps	
Internal Resistance	5.8mOhms (fully charged)	
Electrolyte	1.300S.G.	
Self Discharge	3% per month (77°F/25°C)	
20 hr Capacity	58 Ah (77°F/25°C)	
10 hr Capacity	55 Ah (77°F/25°C)	
5 hr Capacity	46.2 Ah (77°F/25°C)	
1 hr Capacity	35.1 Ah (77°F/25°C)	
Max discharge current	550A (5s) (77°F 25°C)	
Design	Cyclic	
<b>Charging: Constant Voltage Charge</b>		
Cycle Use	14.4-14.7V	
Maximum charging current	18 A	
Temperature compensation	-30mV/°C	
Standby Use	13.6-13.8V	
Temperature compensation	-20mV/°C	



## Discharge Constant Current (Amperes at 77°F 25°C)

End Point Volts/Cell	5 min	10 min	15 min	30 min	1h	3h	5h	10h	20h
1.60V	170	125	96.4	57.4	35.1	15.1	9.8	5.66	2.91
1.65V	160	120	92.5	55.7	34.3	14.6	9.5	5.61	2.91
1.70V	150	112	87.9	53.9	33.3	14.3	9.4	5.55	2.91
1.75V	141	103	83.2	52.2	32.5	14.0	9.2	5.50	2.90
1.80V	130	96.8	77.1	50.3	31.7	13.7	9.0	5.45	2.90

## Discharge Constant Power (Watts at 77°F 25°C)

End Point Volts/Cell	5 min	10 min	15 min	30 min	45 min	1h	2h	3h	5h
1.60V	308	231	179	108	82.7	70.3	40.7	30.3	19.4
1.65V	291	218	172	106	81.5	68.7	39.8	29.7	19.2
1.70V	273	207	164	104	79.8	67.2	39.0	29.0	18.8
1.75V	253	194	157	102	78.1	65.7	38.0	28.5	18.6
1.80V	241	180	149	101	76.0	65.7	37.1	27.9	18.5

## Operating temperatures

Charging	-4°F/-20°C to 140°F/60°C
Discharge	14°F/-10°C to 140°F/60°C
Storage	-4°F/-20°C to 140°F/60°C

